

Installation guide wall heating water

Water-bearing low temperature wall heating system based on clay

Mounting on walls

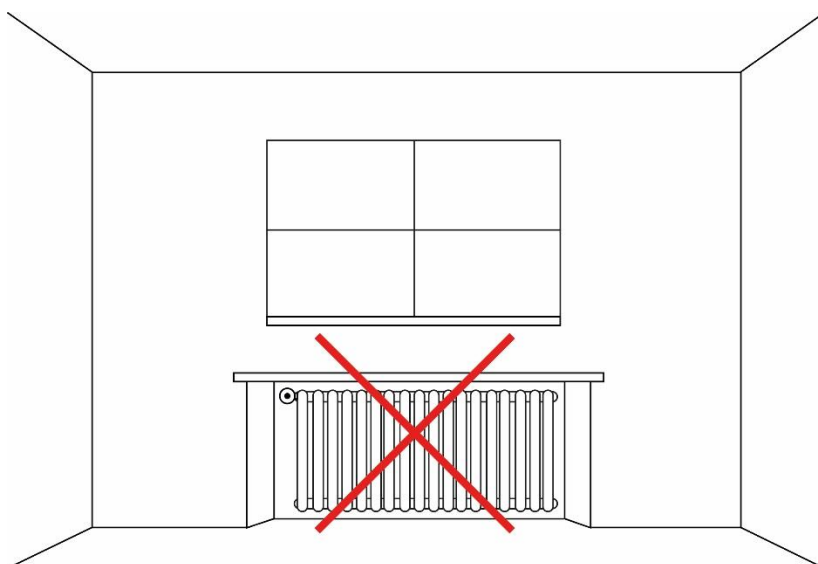

For renovations:

Remove radiators, brick up the niche and plaster.

Remove existing plaster from the window reveal.

Use the cable finder to locate the power lines under the plaster and mark the route to prevent damage.

Execution: Construction company/dry builder

1

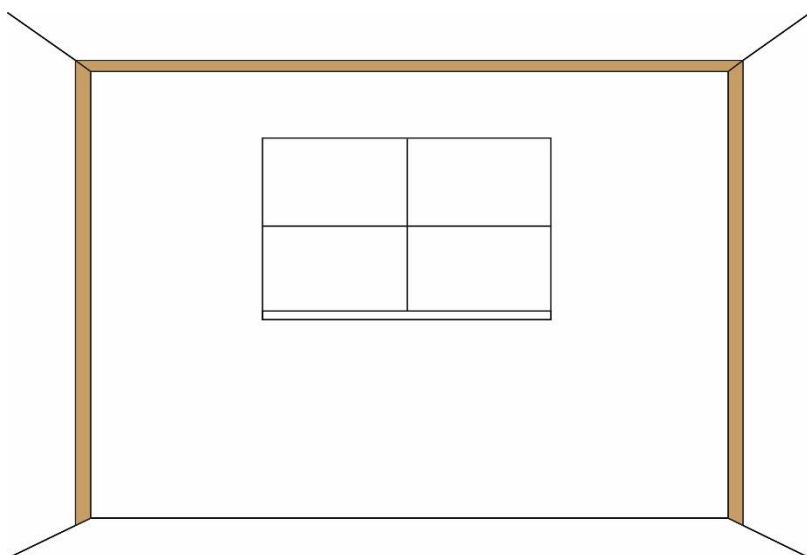

Edge insulation strip 50x10mm

to the ceiling and walls (not to the floor).

The use of soft wood fibre materials is recommended.

Execution: Construction company/drywall builder



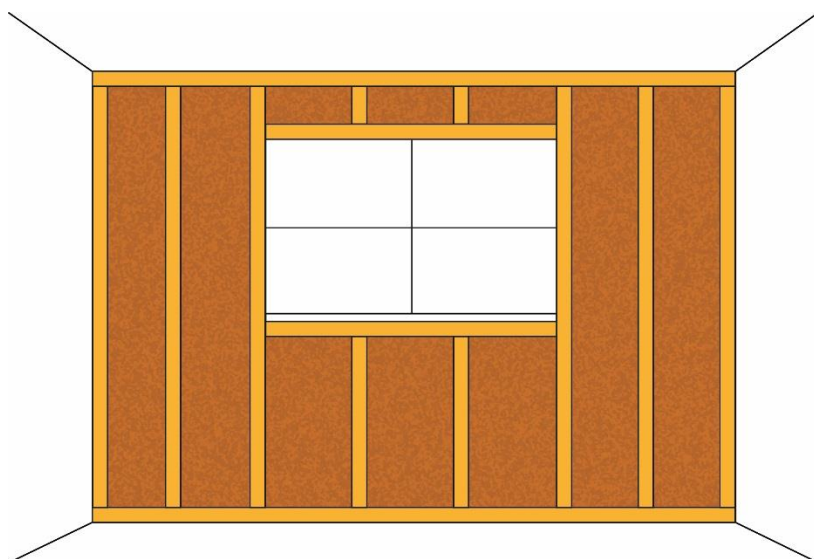

For insufficiently insulated exterior walls:

Install the substructure made of wooden battens or metal profiles and insulate the gaps accordingly.

Recommendation: Wood fibre insulation

Execution: Construction company/drywall builder

2

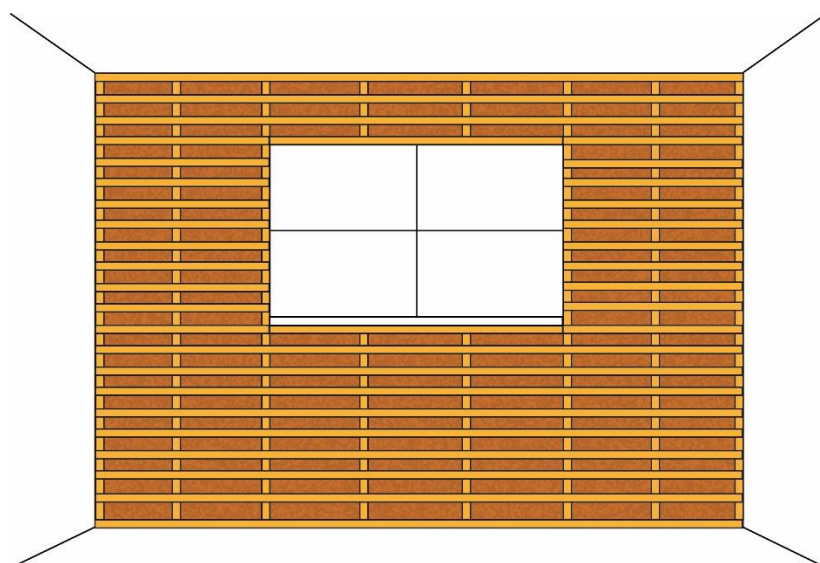

Installation without ESB-Plus chipboard

Mount cross battens made of wooden battens or metal profiles at a distance of 18.75cm.

Execution: Construction company/drywall builder



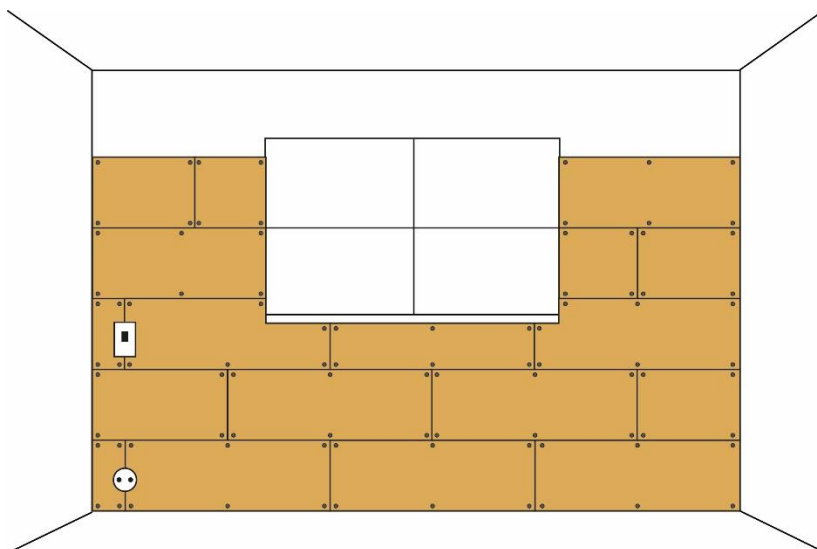

Installation with ESB chipboard

Fix 22mm ESB-Plus P5 chipboard either directly to the brickwork (if the outer wall is sufficiently insulated) or to the substructure with suitable fixing material.

Always use chipboard with tongue and groove joint in the bond. Before installation, the cut-outs for sockets, switches, etc. must be made.

Important: Lay the chipboard in such a way that it does not end flush with the window, but is notched. This prevents cross joints at the window corners.

Execution: Construction company / drywall builder

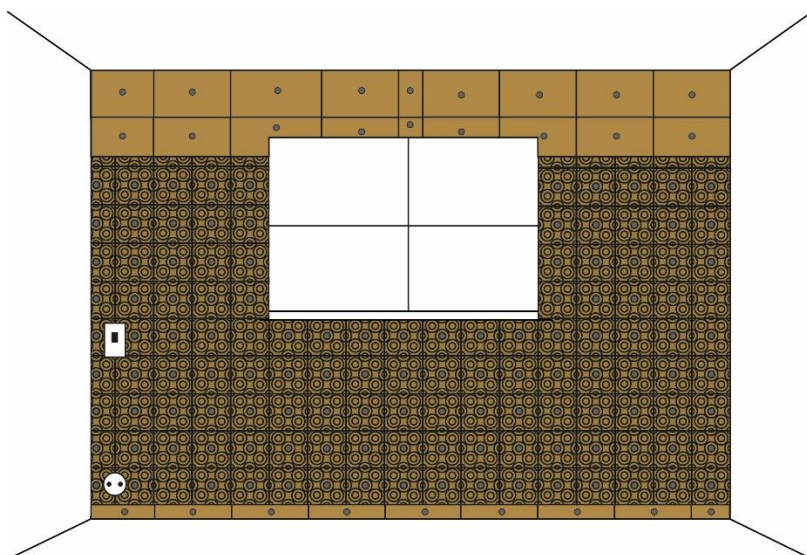

Lay the high-performance clay modules (quantity according to design) on cross joint and fasten only in the middle with a screw.

The remaining surfaces should also be covered with ArgillaTherm® clay compensation panels on cross joints.

Use stainless steel screw load distribution discs 5/50 from ArgillaTherm® and suitable stainless steel construction screws!

Important: Lay the high-performance clay modules in such a way that they do not end flush with the window but are notched. This prevents cross joints at the window corners.

Leave grooved and compensating panels of the same thickness as the panels for the reveal lining in the window protruding.

Execution: Construction company / drywall builder

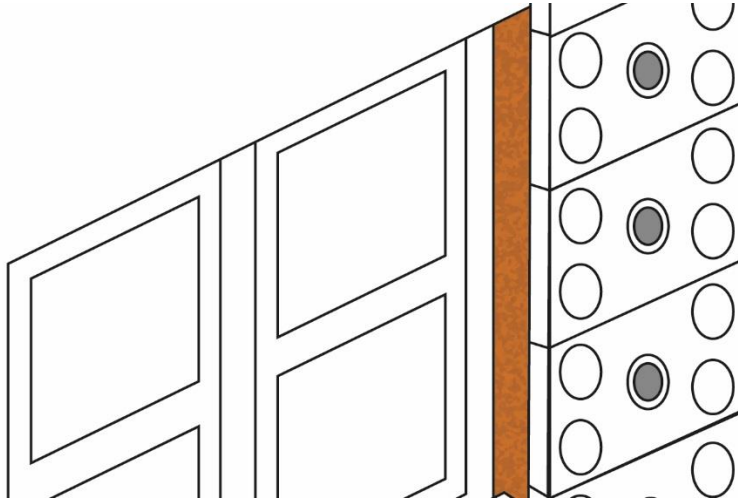

Fix the plastering strips to the window frame.

Line the window reveal either with clay compensation panels or wood-fibre insulation strips.

Execution: Construction company / drywall builder

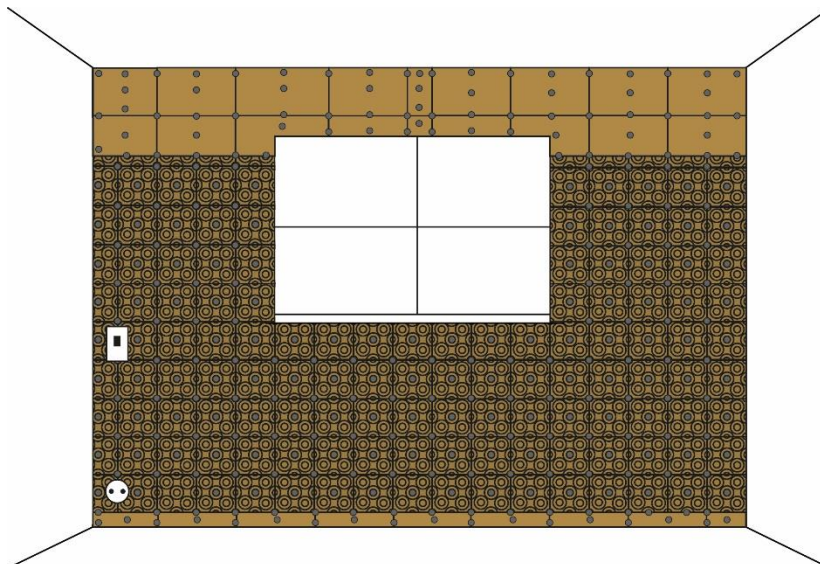

After the wall is completely covered, screw together all cross points and connections of the high-performance clay modules and the clay compensation panels.

It is essential to observe: The joints of the grooved and compensation panels should not be directly above the joints of the chipboards.

Execution: Construction company / drywall builder



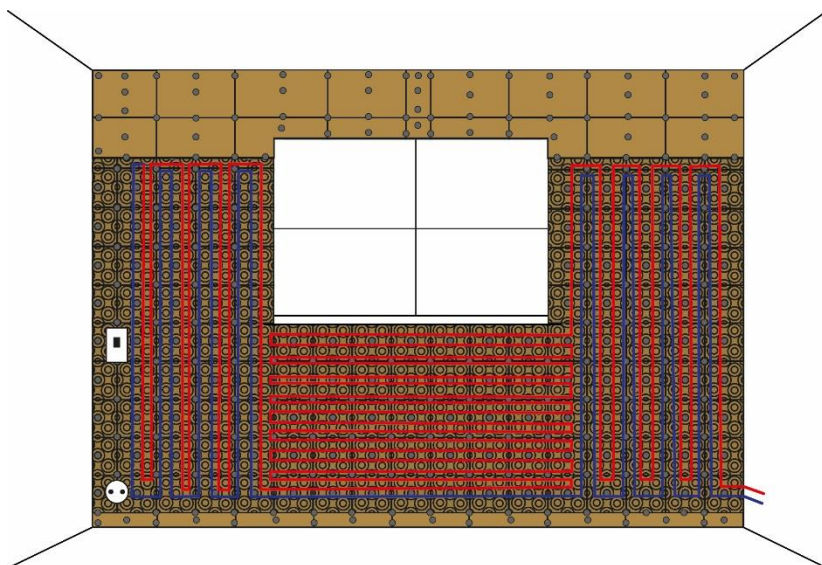

Meandering installation of the ArgillaTherm® PB plastic pipe in the grooves of the high-performance clay modules, starting at the heating circuit distributor or return temperature limiter.

To jam the pipe after each reversal, pull it slightly in the direction of installation.

Labeling heating circuits (VL1, RL1, etc.)

Perform leak test with compressed air.

Important: Use a pipe winder!

execution: heating engineer

5

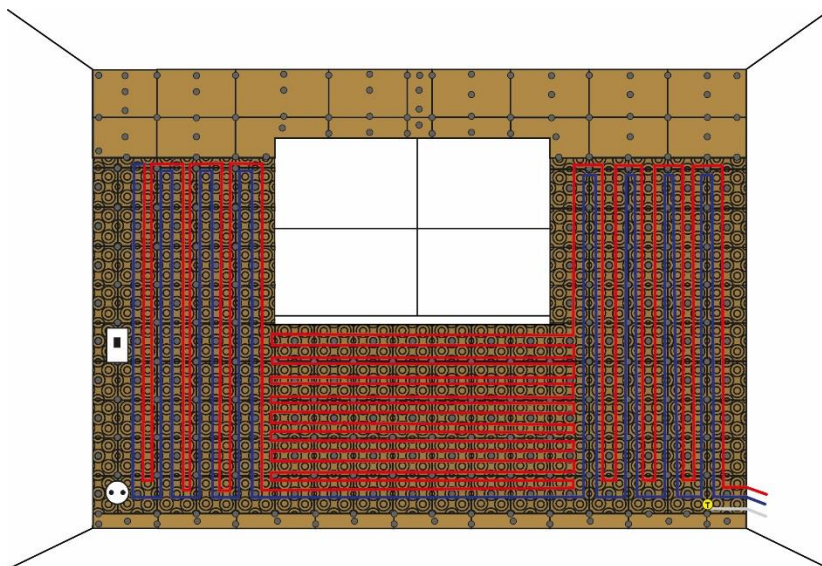

Installation of the wall sensor without empty conduit in the groove.

Place the white sensor head **3cm** from the nearest **return pipe** and **at least 10cm** from the wall!

execution: heating engineer



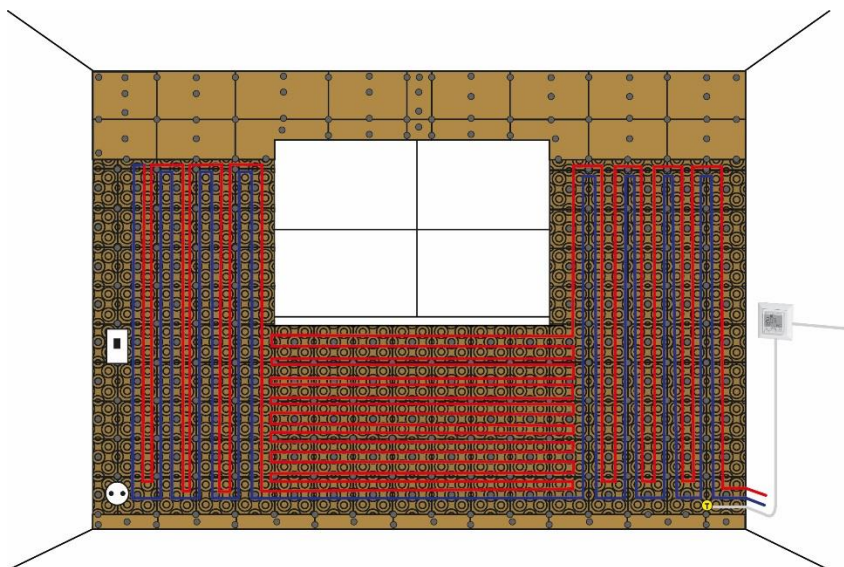

Installation of the ArgillaTherm® room thermostat (free choice of location).

Connect the wall sensor and connect the thermostat to the control valves on the heating circuit manifold using a cable (recommended 5 x 1.5mm²).

When using a return flow temperature limiter (recommendation: Simplex F11836), connect the thermostat to the temperature limiter.

*Execution: heating engineer/
electrician*

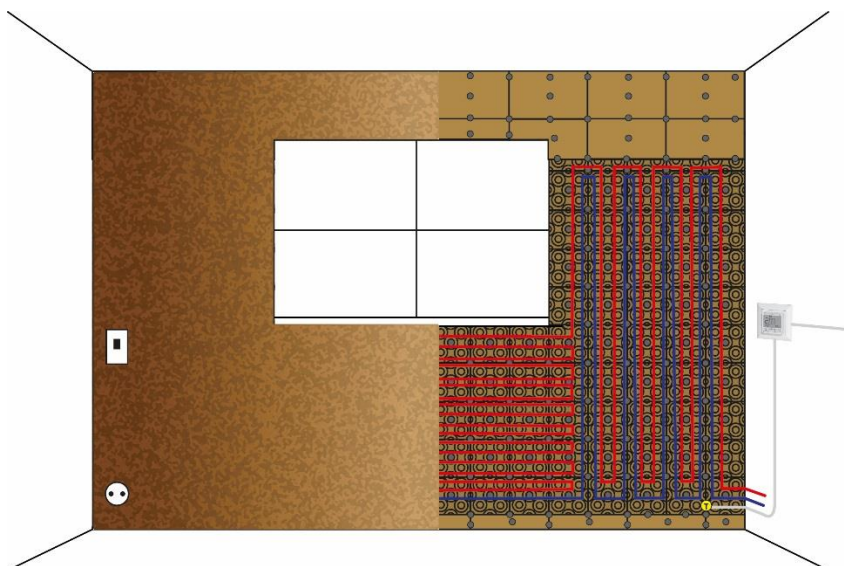

Slightly pre-moisten the clay panels

Fill the grooves of the high-performance clay modules with THERMO clay plaster and allow to dry.

Attention: Filling up the grooves should be done promptly after the heating tubes have been inserted. Damp work such as screeds or plastering should be completed before installing the high-performance clay modules.

*Execution: Construction company /
drywall builder*

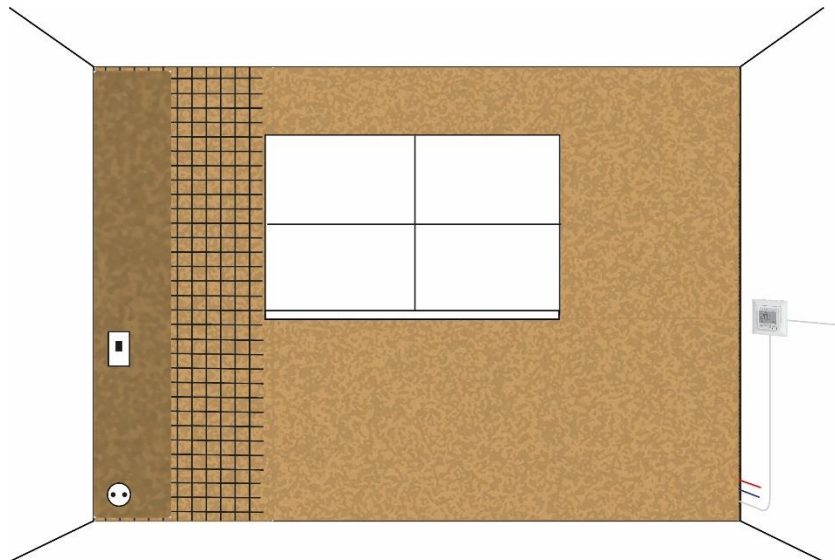

Apply a **3-5mm compensation layer** of THERMO clay plaster with a suitable notched trowel and work in reinforcing fabric with sufficient overlap, followed by a **2mm top layer** and allow to set.

With rounded corners, lay the reinforcing fabric around the edge in the window reveal.

In case of sharp corners, work in suitable fabric corner angles and overlap with the reinforcing fabric.

The surface should be smoothed as much as possible!

Execution: Construction company / drywall builder

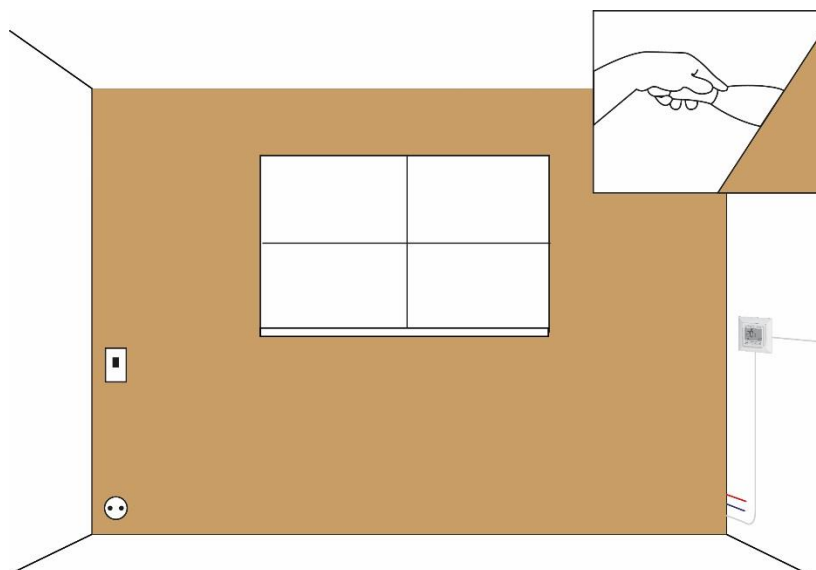

Create a direct connection joint to the ceiling and walls by means of a trowel cut.

Execution: Construction company / drywall builder



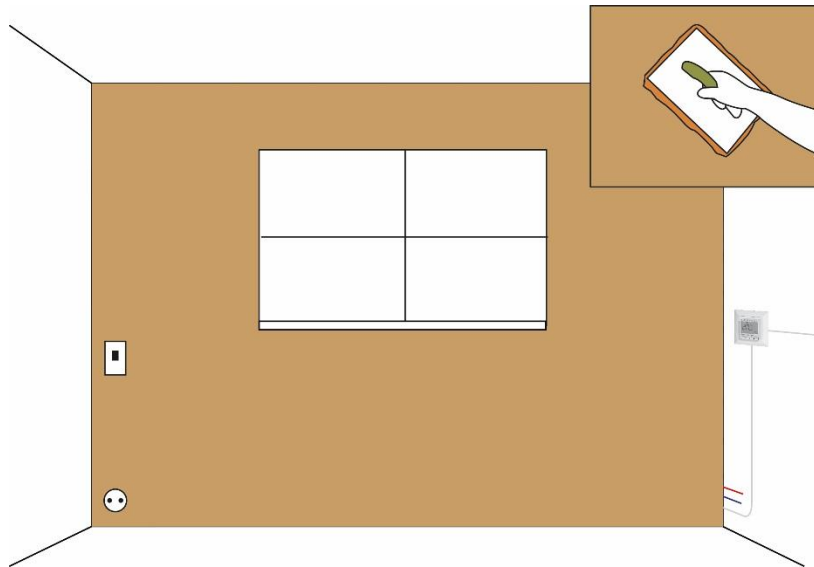

After sufficient tightening (leather-hard) smooth the surface with a suitable sponge trowel or a special felting machine in surface quality Q2.

Execution: Construction company / drywall builder

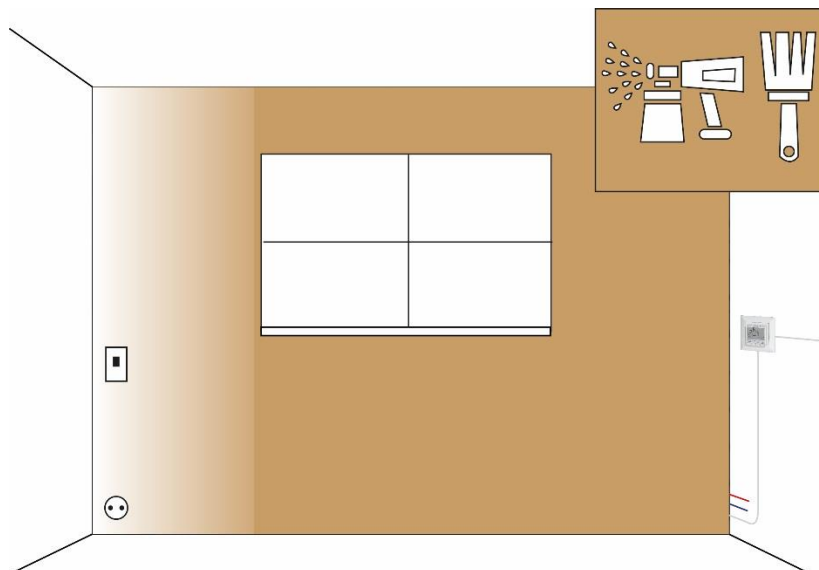

Application of the clay paint (standard or acoustic paint) by brushing or spraying twice.

For a uniform appearance, the clay paint should be finished in one working day with a mixture over the entire surface.

*Execution: Construction company / drywall builder
End customer*



System requirements

- ✓ Structural requirements and overlapping trades are to be taken into account or planned accordingly.
- ✓ For direct wall mounting: the requirements on the masonry according to DIN 18560 must be taken into account. The surfaces must not show any major unevenness. The values of DIN 18202 form the basis.
- ✓ Depending on the wall substructure, sufficient fixing points with screw load distribution discs from ArgillaTherm® must be used to fix and secure the high-performance clay modules. The recesses provided for this purpose in the high-performance clay modules must be used.
- ✓ Objects to be attached to the ArgillaTherm® clay panel heating system, such as pictures, may only be screwed on and not nailed. Before doing so, it is essential to determine the exact position of the heating elements using a thermo foil.
- ✓ Drill holes in the ArgillaTherm clay panel heating system may only be drilled without hammering. Hammer blows, percussion drills, hammer drills and impact wrenches must not be used here to avoid the possible formation of cracks caused by this.

System Guarantee

With professional installation by ArgillaTherm® certified specialist tradesmen, observance of and compliance with the system requirements and use of the specified products in compliance with the work processes according to the installation instructions, the company ArgillaTherm GmbH assumes

Guarantee for the high-performance clay modules of the water-bearing clay panel heating system of 20 years.

9

Exclusions

A warranty from ArgillaTherm is generally excluded for such defects in the clay panel heating system that

- are based on building movements caused by building subsidence or natural forces.
- are caused by damage to the heating materials or the sensors required for control and their electrical cables.
- are based on vibrations of tools, such as hammer blows, impact drills, hammer drills and impact wrenches, the use of which is expressly prohibited.

